



**Small Business
Development Center**
UNIVERSITY OF GEORGIA

Map and directions to the University of Georgia SBDC in Athens



**382 East Broad St.
Athens, Ga 30602**

We are located at the
corner of Broad and
Spring Streets.

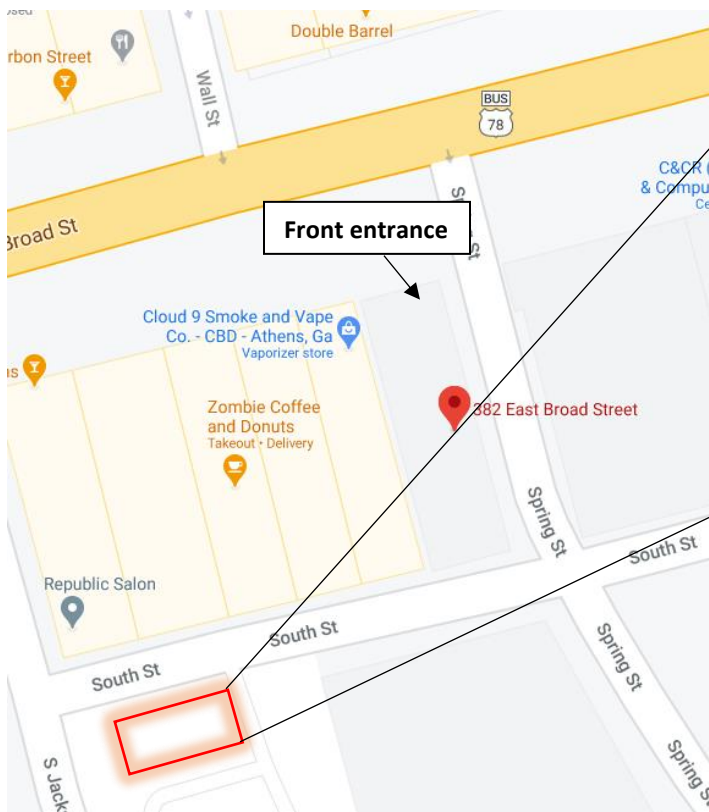

We have several visitor parking spaces
behind the building at the corner of
South Jackson and South Street.

Directions

Once you park, walk toward downtown and take a right onto East Broad street. Walk until you reach the end of the block- the SBDC should be on your right at the corner of Spring Street and Broad. Once you enter, walk straight down the hall in front of you to office number 108 – SBDC Reception (on your left).

Driving in from the East

When approaching from the East on U.S. 78, travel toward downtown Athens. After passing the Super WalMart on your right, you will continue toward downtown Athens. Continue straight until you reach the five-way intersection (approx. 1.8 miles), and go straight through the light onto East Broad St. Then make a left onto S. Jackson Street and the visitors parking spaces will be on your left immediately after you pass South Street.

Driving in from the West

Approaching Athens eastbound on U.S. 78, you will continue driving straight on from Atlanta Highway that leads to West Broad St. West Broad Street will take you to downtown passing by the University of Georgia arches on your right. Take a right onto S. Jackson Street and the visitors parking spaces will be on your left immediately after you pass South Street.

Driving 78 East to Highway 316

Take Highway 316 to Athens. Highway 316 will become Epps Bridge Road when it crosses the Athens Bypass (Loop). Home Depot will be on the right. Stay on Epps Bridge Road that leads into West Broad Street. West Broad St. will take you to downtown Athens. The University of Georgia arches will be on your right. Take a right onto S. Jackson Street and the visitors parking spaces will be on your left immediately after you pass South Street.

Driving in from Watkinsville (South of Athens)

Driving North on 441, get on the bypass (Loop 10) going East. Then take the Downtown Athens/Airport exit (# 8). Turn left at the end of the exit ramp (towards Athens). Continue straight until you reach the five-way intersection (approx. 1.8 miles), and go straight through the light onto East Broad St. Then make a left onto S. Jackson Street and the visitors parking spaces will be on your left immediately after you pass South Street.

Driving in from Commerce (North of Athens) via 441

From Commerce, GA, Interstate 85, take U.S. 441 South. Continue under the Athens Perimeter (Loop 10) onto Dr. Martin Luther King Jr. Pkwy. Continue straight, then take a right onto E. Broad Street. Continue straight on E. Broad through the five-way intersection, then take a left onto S. Jackson Street. The visitor's parking will be on your left immediately after you pass South Street.

Driving in from Danielsville (North of Athens) via 29

Remain on U.S. 29 South until you reach the Athens Perimeter. Enter the Perimeter traveling westward, and take the first exit, North Avenue. Turn left onto North Avenue and proceed to the traffic light at the intersection of North Avenue/Martin Luther King Parkway. Take a left onto Dr. Martin Luther King Pkwy, then take a right onto East Broad Street. Continue straight on E. Broad through the five-way intersection, then take a left onto S. Jackson Street. The visitor's parking will be on your left immediately after you pass South Street.